

## 50.0MM CIRCULAR BLACK

<b>Status</b>	Production
<b>Part no.</b>	10306
<b>Drawing no.</b>	60443
<b>No. of optics</b>	3
<b>No. of legs</b>	3
<b>Pin length</b>	0.8
<b>Related Optics</b>	<p>10194 20.0 mm Frosted Narrow Catadioptic            10195 20.0 mm Frosted Medium Catadioptic            10209 20.0 mm Ripple Wide Catadioptic            10196 20.0 mm Frosted Wide Catadioptic            10197 20.0 mm Elliptical Catadioptic            10198 20.0 mm Elliptical Orthogonal Catadioptic            10208 20.0 mm Ripple Medium Catadioptic            10193 20.0 mm Plain Tight Catadioptic            10199 20.0 mm Plain Tight Catadioptic            10200 20.0 mm Frosted Narrow Catadioptic            10210 20.0 mm Ripple Medium Catadioptic            10201 20.0 mm Frosted Medium Catadioptic            10211 20.0 mm Ripple Wide Catadioptic            10202 20.0 mm Frosted Wide Catadioptic            10203 20.0 mm Elliptical Catadioptic            10204 20.0 mm Elliptical Orthogonal Catadioptic            10170 20.0 mm Wide Angle Reflector TIR            10003 20.0 mm Plain Tight Catadioptic            10138 20.0 mm Frosted Narrow Catadioptic            10003/15 20.0 mm Ripple Medium Catadioptic            10139 20.0 mm Frosted Medium Catadioptic            10003/25 20.0 mm Ripple Wide Catadioptic            10140 20.0 mm Frosted Wide TIR            10003/L25 20.0 mm Elliptical Catadioptic            10192 20.0 mm Elliptical Orthogonal TIR</p>
<b>Related LEDs</b>	<p>Cree XLamp® XR®            Cree XLamp® XR-EA®            Cree XLamp® XR-C®            Cree XLamp® MC-E            Osram Dragon Golden Dragon W5SG            Osram Dragon Golden Dragon W5SM            Osram Dragon Platinum Dragon W5SN            Osram Dragon Dragon Plus W5AM</p>
<b>Files</b>	<a href="#">Customer drawing (PDF)</a>

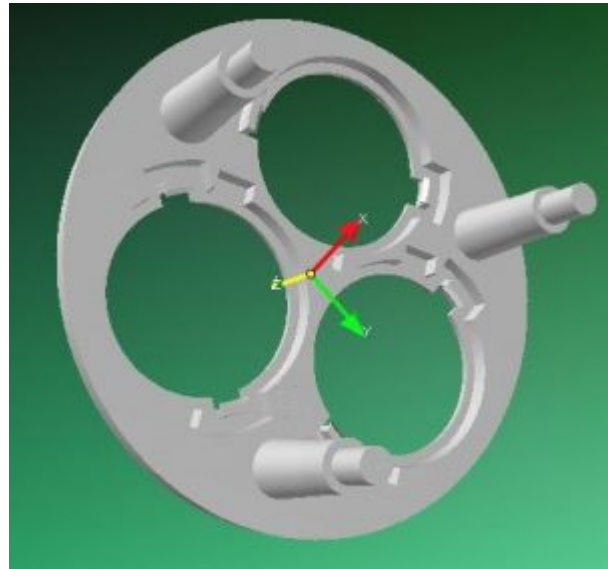

Carclo Technical Plastics endeavours to continuously improve and renew its products; for this reason the technical data and contents of this catalogue may undergo variations without prior notice. For correct and up to date information, Carclo suggest using the Opticselect tool on our website <http://www.carclo-optics.com>.  
Copyright © Carclo 2010

### Handling instructions

- Do not handle or install lenses without wearing gloves, skin oils may damage the lens or the light transmission.
- Clean lenses with a mild soap and water and dry with a clean soft cloth.
- Do not use any commercial solvents on lenses.
- Mount holders with low Odour epoxy's and allow time for them to out gas to stop lenses fogging.

Please note that flow lines, weld lines, surface scratches and small black or white inclusions within the lenses are acceptable if the optical performance of the lens is within the specification described to +/-10%. FWHM-Full (beam) Width as measured at one Half of Maximum intensity, information shown in the catalogue are based on our laboratory's tests.

All rights reserved. No part of this publication may be copied, reproduced in any form or by any means, electronic, mechanical, photocopying, recording or otherwise, illustrations not to be removed, without our prior permission. Carclo Technical Plastics reserves the right to make changes at any time in order to supply the best products possible.